

12521

ACADEMY
HOBBY MODEL KITS**CAUTION!****-주의-**

<READ THIS BEFORE YOU BEGIN>
 <ALLGEMEINE HINWEISE>
 <LISEZ CE QUI SUIT AVANT DE COMMENCER LE MONTAGE>
 <組み立てる前に>
 <조립하기 전에 먼저 읽어 주십시오>

<LISEZ CE QUI SUIT AVANT DE COMMENCER LE MONTAGE>

- Étudier les schémas d'assemblage. - Contrôler que chaque pièce soit bien conforme avant de la coller à sa place.
- N'utiliser pas trop de colle pour réunir les pièces. - Ne jamais manipuler la colle ou peinture à proximité d'une flamme.
- Aller soigneusement la pièce où vous allez coller la tenir.
- Après avoir sorti les pièces du sac en plastique, dévider le sac afin d'éviter que les enfants ne le mettent sur la tête et ne s'étouffent.

<組み立てる前に>

- 組み立てる前に説明書をお読み下さい。-部品をランナーから取り出すには鋭利なニッパーとカッターを使用します。
- 接着剤を少し少なめに使うことがポイントに仕上げることです。-接着する前に部品を合わせて確かめます。
- 接着剤や塗料を使用する時はときどき手を洗って機油に汚さないようにしましょう。
- 組み立て後の部品やニール袋は小さな子供の手の届かない安全な所に保管して下さい。

<조립하기 전에>

- 부품을 조립하기 전에 설명서를 잘 읽어본 후 조립한다.
- 접착하기 전에 부품을 맞추어 확인한 후 조립한다.
- 부품을 자를 때에는 칼이나 니퍼를 깨끗이 씻어준다.
- 접착제를 사용할 곳과 사용하지 않는 곳에 주의하고 너무 많이 바르지 않도록 한다.
- 어린 어린이는 접착제를 사용할 때는 장문을 열어 환기를 시키고 화기를 멀리한다.
- 사용 후 남은 부품은 어린 아이들의 손이 닿지 않도록 처리한다.

<ALLGEMEINE HINWEISE>

- Die Anordnung der Bauteile ist aus den Zeichnungen der Anleitung ersichtlich.
- Die Teile vor dem Verkleben ungeleimt zusammenhalten, um ihren Platz zu prüfen.
- Klebstoff nicht zu dick auftragen. - Klebstoff und Farben niemals in der Nähe einer Flamme verwenden.
- Während der Bemalung mit Spritzpistole oder Pinsel für frische Luftzufuhr, z.B. öffnen des Fensters, sorgen.
- Bauteile von kleinen Kindern fernhalten. Verhüten Sie, daß Kinder irgendweiche Bauteile in den Mund nehmen oder Plastikfenster über den Kopf ziehen.



MAIN COLOR	FLAT BLACK FS 37038 무광 검정색				GLOSS WHITE FS 18785 유광 흰색				LIGHT GULL GRAY FS 36231 라이트 갈 그레이							
	Humbrol		AQULEUS/DRAGON/DR		GSI Crees		Mr. COLOR		Lifecolor		TESTORS / MODELMASTER		Revell		Vallejo	
PAINT INDEX	ENAMEL	ACRYL	AQULEUS/DRAGON/DR	MR. COLOR	LIFECOLOR	ENAMEL	MODELMASTER	ENAMEL	REVELL	MODEL COLOR	MODEL AIR	ENAMEL	REVELL	MODEL COLOR	MODEL AIR	
▼ GLOSS BLACK FS 17038	21	21	H2	2	LC72	1747	4695	32107	36107	861						유광 검정색
▼ GLOSS RED FS 31136	19	19	H327	327	LC56	1503	2741	32132	36132	957	84					유광 빨간색
▼ GLOSS YELLOW	188		H4	4	LC53	1707	4683	32310	36310	953						유광 노란색
▼ SILVER FS 17178	11	11	H8	8	LC74	2914	4678	32190	36190	997	63					실버
▼ STEEL	53	53	H18	28	LC76	1795	4681	32191	36191	863	72					스틸
▼ FLAT BLACK FS 37038	33	332	H12	33	LC02	1749	4768	32108	36108	950	57					무광 검정색
▼ BURNT IRON			H76	61												번진 아이언
▼ CLEAR RED	91321		H90	47			4630							934		투명 빨간색
▼ CLEAR BLUE	1320		H93	50			4758							938		투명 파란색
▼ OLIVE DRAB FS 34087	155		H52	12	UA003	1711	4728			887	43					올리브 드라프
▼ KHAKI FS 36077	26	26	H81	55	UA304	1704	4711	32189	36189	879	23					카키
▼ GLOSS WHITE FS 17875	22		H316	316	LC51	1745	4696	32104	36104	842						유광 흰색
▼ LIGHT GULL GRAY FS 36231	183		H315	315		1729	4692									라이트 갈 그레이
▼ DARK GULL GRAY FS 36231	140		H317	317	UA033	1740	4755	32179	36179	893						다크 갈 그레이
▼ ZINC CHROMATE THIN FS 34151	151		H58	351	UA004	1715	4735			931	10					징크 크로메이트
▼ TAN FS 10115	9		H27	44	LC65					981						탄

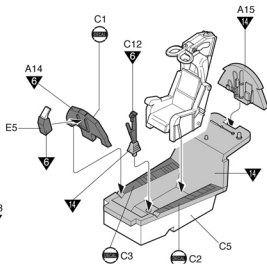
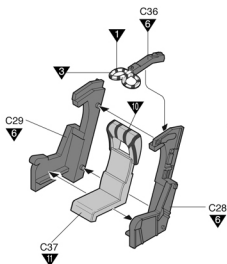

※ Remove surface detail before applying decal.

전사지를 붙일 경우면 붙일 면의 디테일을 깨끗이 밀어낸 뒤 붙여 주십시오.

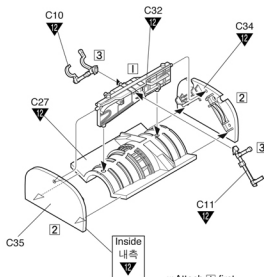
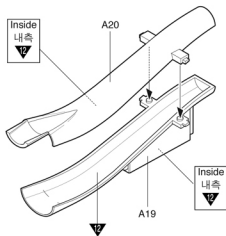

※ Attach ① first.

① 번부터 조립합니다.

3

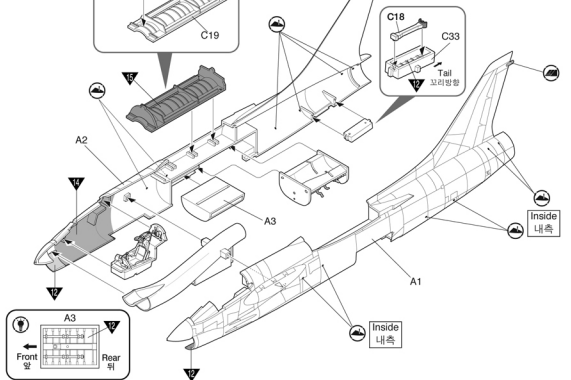
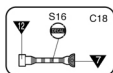
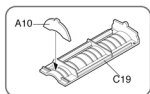

4

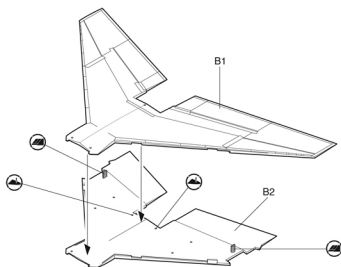

5 

1  1 or 1-1
또는
2  21

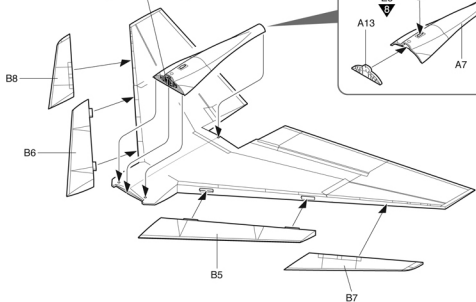

6 

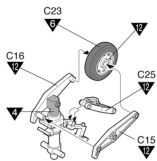

Closed
닫힌상태

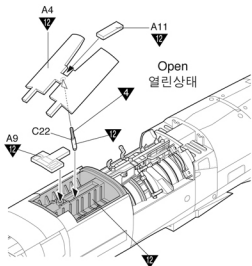
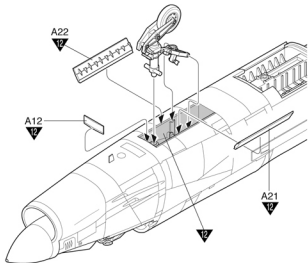
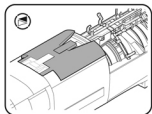

Open
열린상태

7 

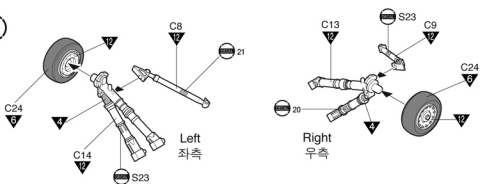

8 

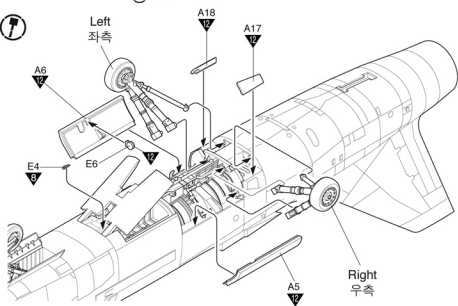

9 

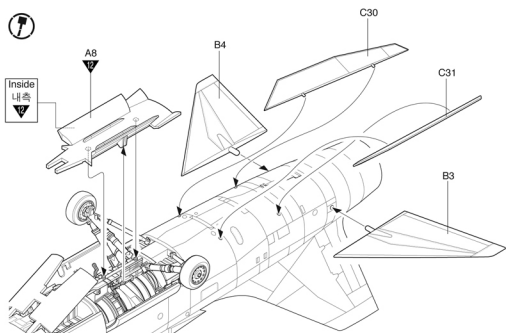

10 

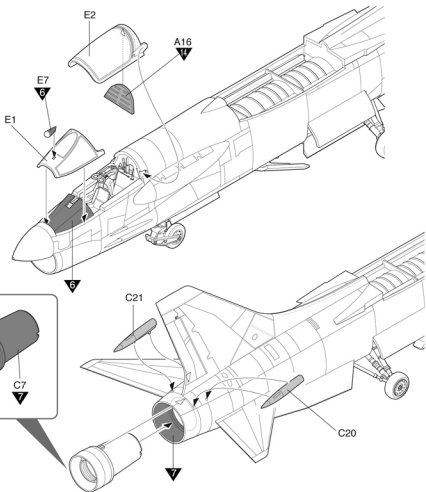

11 

Left/좌측:C1
Right/우측:C2

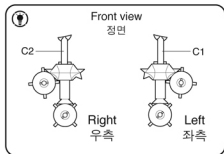
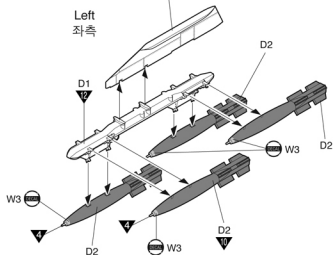

12

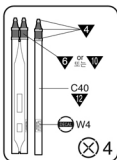
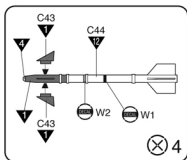

C38(C38)

※ () is opposite number.
() is 반대측 번호입니다.

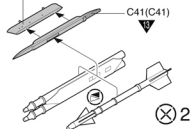

Right
우측

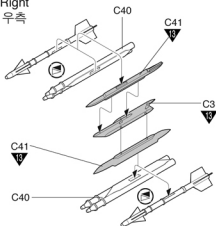

Left
좌측

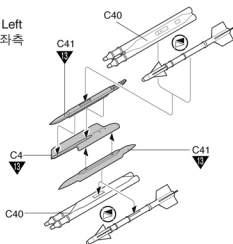

13



Right
우측

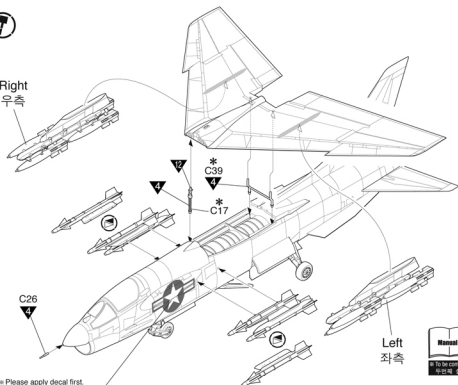

Left
좌측

※ Please apply decal first.
국적마크 전사지 C12번을 먼저붙인 후, 무장을 장착해 주십시오.

※ : C17, C39 are used for wing up position only.
C17, C39 부속은 날개를 내린상태로 조립시엔 사용하지 않습니다.



To fit consistent normal second time
후의에 실용시로 이어집니다.

A

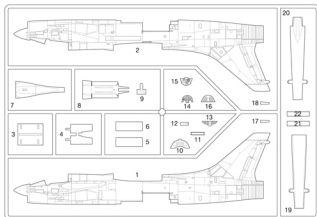

B

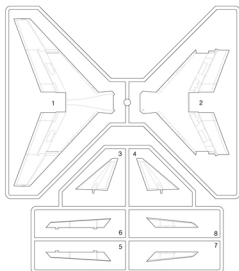

C

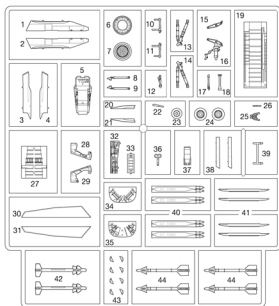

D



E



● Decal/전사지

● Unused parts/불필요 부품
C42, E8

▶ painting & decal placement/ 색칠 및 전사지불이기

-COMMON DATA-
공통데이터

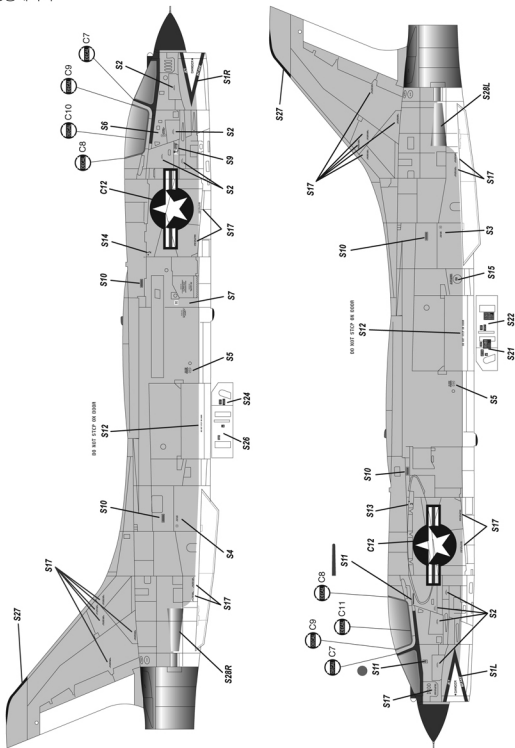

-COMMON DATA-
공통데이터

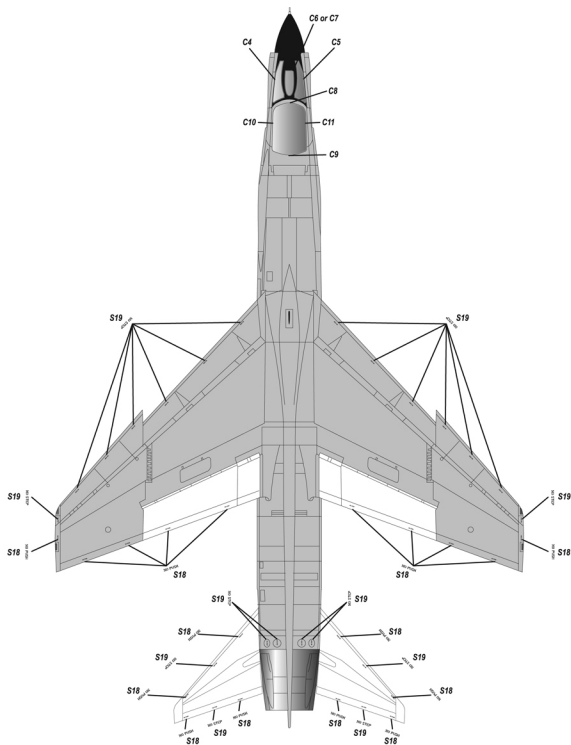

2

F-8E U.S. Navy VF-103 "Sluggers" BuNo. 15030, USS Forrestal (CVA-59), 1964

ACADEMY
HOBBY MODEL KITS

ACADEMY
ACADEMY PLASTIC MODEL CO., LTD.
2014 Reproduction. All Rights Reserved. Copyright © Hobby Model Kits

